

## Unpacking

Made in China

Before you begin using the device, please check the version you got and ensure that the following items are included in the shipped box:

### Mainframe Accessories (Please find in device box):

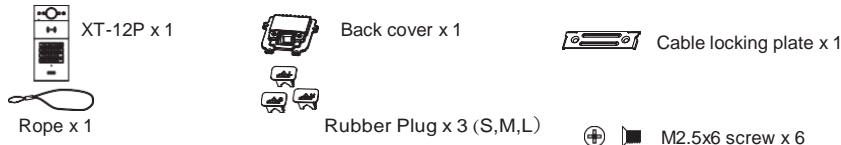

### Flush-mounting Accessories:

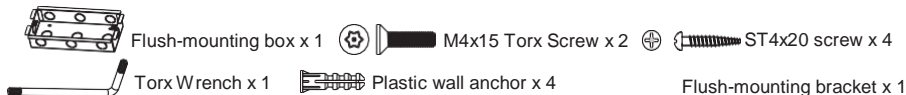

## Product Overview

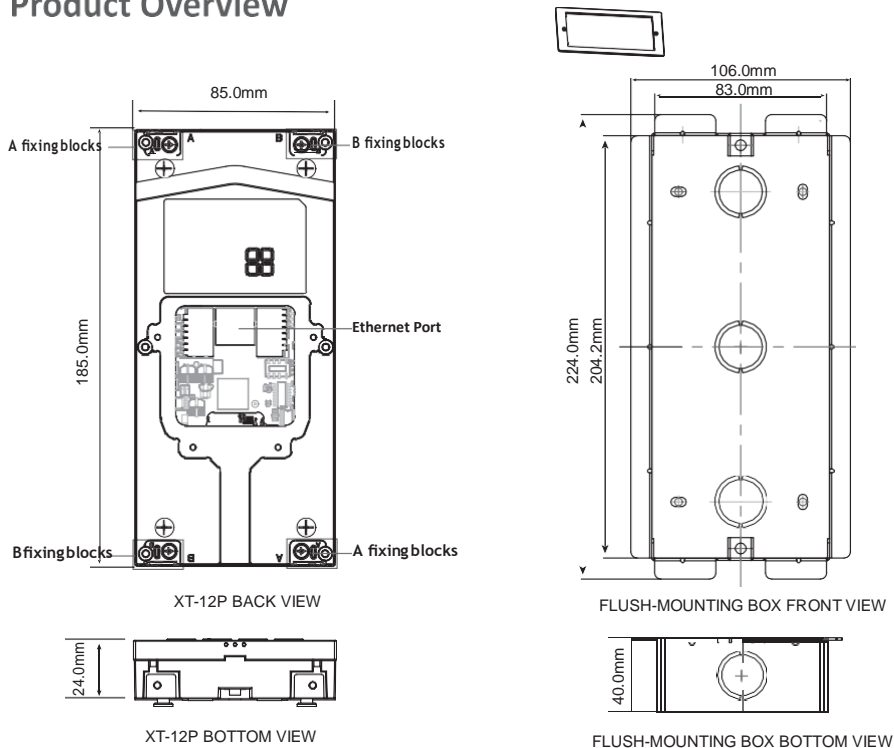

# Installation Environment

Indoor and outdoor installation are supported.

If installing the device outdoors, please don't place device under direct sunlight, it will bring a bad effect or be broken with the high temperature.

If installing the device indoors, please keep device at least 2 meters away from light, and at least 3 meters away from window and door.

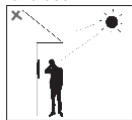

Backlight

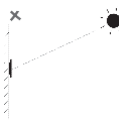

Direct sunlight

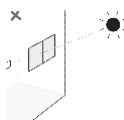

Direct sun through window

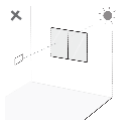

Indirect sunlight through window

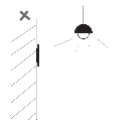

Close to light

## Flush-mounting Installation

### Step 1: Flush-mounting Box Installation

#### 1. Normal Installation

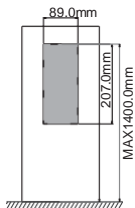

Cut a rectangular hole on the wall of

the diameter of 89x207 mm and depth the hole of 40 mm that can accommodate and throughout all necessary cables.

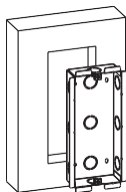

Insert the flush-mounting box into

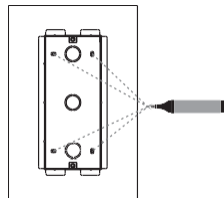

Mark the four holes of the

flush-mounting box on the wall.

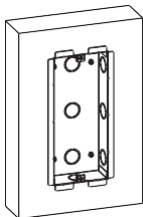

Finish the flush-mounting box installation.

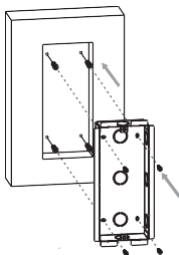

Insert four plastic wall anchors into the hole you drilled before. Fix the flush-mounting box with four ST4x20 screws.

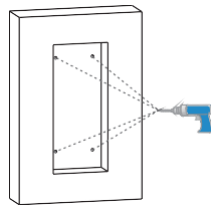

Take down the flush-mounting box and drill (5 mm drill bit required) the four marked fixing holes on the wall with a depth of 25 mm.

## 2. Or you can choose another simple method without fixing ST4x20 screws

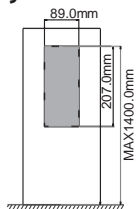

Cut a rectangular hole in the wall of the diameter of 89x207 mm and depth of 40 mm that can accommodate and throughout all necessary cables.

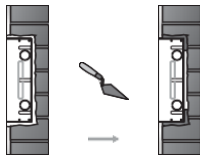

Use cement or non-corrosive structural adhesives to fill the gap between the wall and flush-mounting box. Wait the adhesive material desiccation, go to the next step.

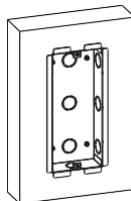

Finish the flush-mounting box installation.

## Step2 : Flush-mounting bracket installation

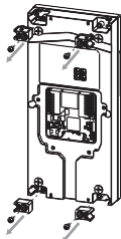

Unscrew the screws and remove the four A/B fixing blocks on the back of the device.

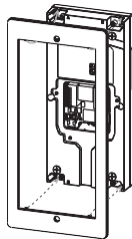

Insert the four bumps of the flush-mounting bracket into the 4 grooves on the back of the device (the foam side faces people).

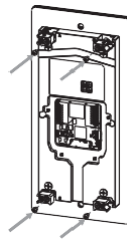

Reinstall the removed fixing blocks back to their original position (A to A, B to B).

## Step3 : Back Cover Installation

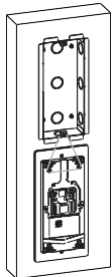

For convenient wiring, hang XT-12P on the flush-mounting box with rope.

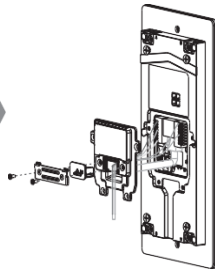

Make cables go through the back cover, connecting to the corresponding interfaces of the main board. Select a suitable size rubber plug to push all the cables into the back cover. Fix cable locking plate to the back cover with two M2.5x6 screws.

Note: In the case of less than 6 signal cables, use S-size rubber plugs. In the case of 7 to 10 signal cables, use M-size rubber plugs. When there are more than 11 signal cables Please use L-size wiring rubber plug.

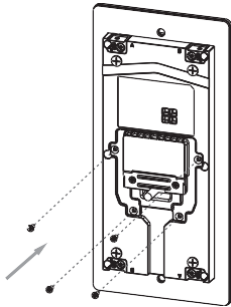

Fasten the back cover with four M2.5x6 screws.

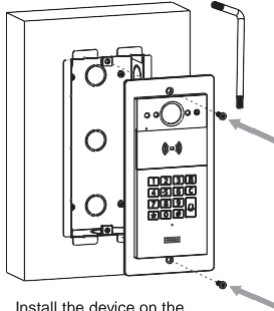

Install the device on the flush-mounting box using two M4x15 Torx screws.

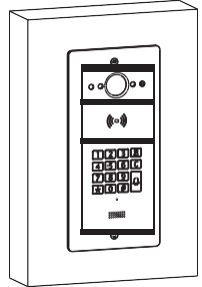

Installation completed.

### ***Notice Information***

XonTel XT-12P firmware contains third-party open source software under the terms of the GNU General Public License(GPL). XonTel is committed to meeting the requirements of the GNU General Public License (GPL) and will make all required source code available.

The source code of software under the terms of GNU GPL can be downloaded online: <http://www.XonTel.com>.

Information contained in this document is believed to be accurate and reliable at the time of printing. This document is subject to change without notice, any update to this document can be viewed on XonTel' s website: <http://www.XonTel.com> © Copyright 2020 XonTel Ltd. All rights reserved.



**XonTeL Technology CO.**  
[www.XonTel.com](http://www.XonTel.com)